

Spirit/ProLine/FineLine Consumable Order Form

| | |
|------------------------|----------------------|
| Company Name: | Phone Number: |
| Contact Name: | Fax Number: |
| E-mail Address: | PO Number: |
| Ship To: | Pages Sent: |

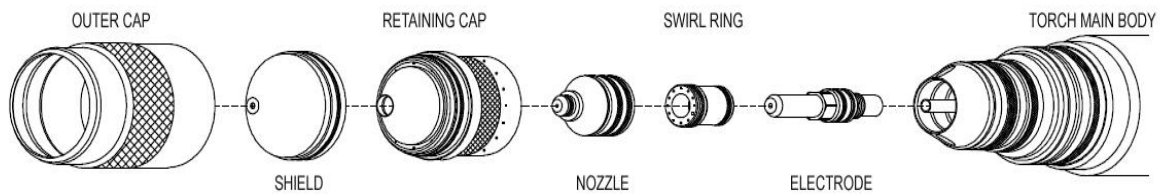

MILD STEEL

| Amperage | Part | Reference | Qty | Amperage | Part | Reference | Qty |
|-----------------------------------|------------|-----------|-----|-------------------------------------|------------|-----------|-----|
| Systems <275amp | Torch Body | 277000 | | 150amp | Shield Cap | 277117 | |
| 400amp Systems | Torch Body | 278000 | | 150amp <12mm | Inner Cap | 277151 | |
| 30amp | Shield Cap | 277145 | | 150amp +12mm | Inner Cap | 277152 | |
| 30amp | Inner Cap | 277153 | | 150amp | Nozzle | 277293 | |
| 30amp | Nozzle | 277120 | | 150amp | Swirl Ring | 277139 | |
| 30amp | Swirl Ring | 277140 | | 150amp | Electrode | 277292 | |
| 30amp | Electrode | 277130 | | 200amp | Shield Cap | 277274 | |
| 50amp | Shield Cap | 277115 | | 200amp | Inner Cap | 277266 | |
| 50amp | Inner Cap | 277153 | | 200amp | Nozzle | 277289 | |
| 50amp | Nozzle | 277122 | | 200amp | Swirl Ring | 277143 | |
| 50amp (cold) | Swirl Ring | 277140 | | 200amp | Electrode | 277291 | |
| 50amp (hot) | Swirl Ring | 277142 | | 275amp | Shield Cap | 277263 | |
| 50amp | Electrode | 277131 | | 275amp | Inner Cap | 277266 | |
| 70amp | Shield Cap | 277150 | | 275amp | Nozzle | 277269 | |
| 70amp | Inner Cap | 277153 | | 275amp | Swirl Ring | 277258 | |
| 70amp | Nozzle | 277125 | | 275amp | Electrode | 277270 | |
| 70amp | Swirl Ring | 277142 | | 400amp | Shield Cap | 284123 | |
| 70amp | Electrode | 277131 | | 400amp | Inner Cap | 284121 | |
| 100amp | Shield Cap | 277286 | | 400amp | Nozzle | 284125 | |
| 100amp | Inner Cap | 277151 | | 400amp | Swirl Ring | 284122 | |
| 100amp | Nozzle | 277284 | | 400 amp | Electrode | 284124 | |
| 100amp | Swirl Ring | 277283 | | 30 - 275amp | Outer Cap | 277154 | |
| 100amp | Electrode | 277282 | | 400 amp | Outer Cap | 284150 | |
| Swirl Ring Removal Tool | | 260105 | | O-Ring (Red-upper – Inner Cap) | | 500018 | |
| Nozzle Removal Tool | | 277056 | | O-Ring (Blue-lower – Inner Cap) | | 500024 | |
| Electrode Removal Tool Driver | | 277086 | | O-Ring (Black/Red – Outer Cap) | | 820209 | |
| Electrode Removal Socket | | 277087 | | O-Ring Lubricant | | 716012 | |
| Electrode Removal Socket - 400amp | | 284052 | | Torch Handle Assembly | | 820134 | |
| Coolant 1-gallon | | 500695 | | Torch Handle Assembly - 400amp only | | 278001 | |

Spirit/ProLine/FineLine Consumable Order Form

| | |
|------------------------|----------------------|
| Company Name: | Phone Number: |
| Contact Name: | Fax Number: |
| E-mail Address: | PO Number: |
| Ship To: | Pages Sent: |

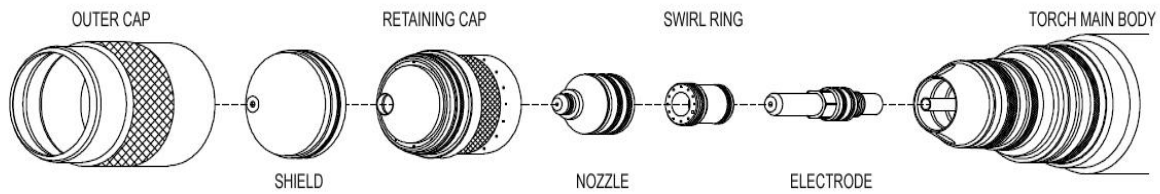

STAINLESS STEEL – Air or Nitrogen

| Amperage | Part | Reference | Qty | Amperage | Part | Reference | Qty |
|-----------------------------------|------------|-----------|-----|-------------------------------------|------------|-----------|-----|
| Systems <275amp | Torch Body | 277000 | | 150amp | Shield Cap | 277117 | |
| 400amp Systems | Torch Body | 278000 | | 150amp | Inner Cap | 277152 | |
| 30amp | Shield Cap | 277144 | | 150amp | Nozzle | 277293 | |
| 30amp | Inner Cap | 277110 | | 150amp | Swirl Ring | 277139 | |
| 30amp | Nozzle | 277121 | | 150amp | Electrode | 277292 | |
| 30amp | Swirl Ring | 277138 | | 200amp | Shield Cap | 277274 | |
| 30amp | Electrode | 277137 | | 200amp | Inner Cap | 277266 | |
| 50amp | Shield Cap | 277149 | | 200amp | Nozzle | 277289 | |
| 50amp | Inner Cap | 277110 | | 200amp | Swirl Ring | 277143 | |
| 50amp | Nozzle | 277123 | | 200amp | Electrode | 277291 | |
| 50amp | Swirl Ring | 277142 | | 275amp | Shield Cap | 277263 | |
| 50amp | Electrode | 277137 | | 275amp | Inner Cap | 277266 | |
| 70amp | Shield Cap | 277150 | | 275amp | Nozzle | 277276 | |
| 70amp | Inner Cap | 277153 | | 275amp | Swirl Ring | 277258 | |
| 70amp | Nozzle | 277125 | | 275amp | Electrode | 277270 | |
| 70amp | Swirl Ring | 277142 | | 400amp | Shield Cap | 284155 | |
| 70amp | Electrode | 277131 | | 400amp | Inner Cap | 284156 | |
| 100amp | Shield Cap | 277286 | | 400amp | Nozzle | 284157 | |
| 100amp | Inner Cap | 277151 | | 400amp | Swirl Ring | 284122 | |
| 100amp | Nozzle | 277284 | | 400 amp | Electrode | 284159 | |
| 100amp | Swirl Ring | 277283 | | 30 - 275amp | Outer Cap | 277154 | |
| 100amp | Electrode | 277282 | | 400 amp | Outer Cap | 284150 | |
| Swirl Ring Removal Tool | | 260105 | | O-Ring (Red-upper – Inner Cap) | | 500018 | |
| Nozzle Removal Tool | | 277056 | | O-Ring (Blue-lower – Inner Cap) | | 500024 | |
| Electrode Removal Tool Driver | | 277086 | | O-Ring (Black/Red – Outer Cap) | | 820209 | |
| Electrode Removal Socket | | 277087 | | O-Ring Lubricant | | 716012 | |
| Electrode Removal Socket - 400amp | | 284052 | | Torch Handle Assembly | | 820134 | |
| Coolant 1-gallon | | 500695 | | Torch Handle Assembly - 400amp only | | 278001 | |

Spirit/ProLine/FineLine Consumable Order Form

| | |
|------------------------|----------------------|
| Company Name: | Phone Number: |
| Contact Name: | Fax Number: |
| E-mail Address: | PO Number: |
| Ship To: | Pages Sent: |

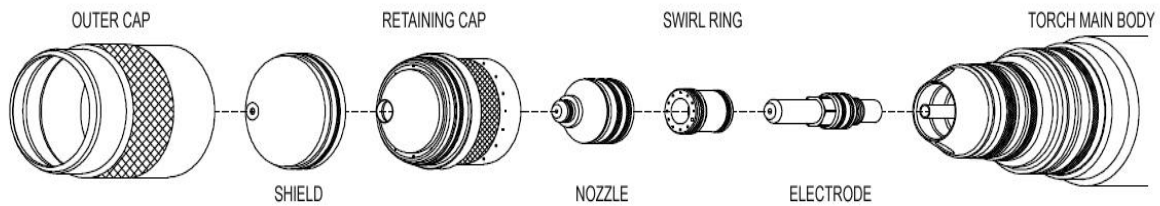

STAINLESS STEEL – H17

| Amperage | Part | Reference | Qty | Amperage | Part | Reference | Qty |
|-----------------------------------|------------|-----------|-----|-------------------------------------|------------|-----------|-----|
| Systems <275amp | Torch Body | 277000 | | 200amp | Shield Cap | 277274 | |
| 400amp Systems | Torch Body | 278000 | | 200amp | Inner Cap | 277266 | |
| 70amp | Shield Cap | 277150 | | 200amp | Nozzle | 277287 | |
| 70amp | Inner Cap | 277113 | | 200amp | Swirl Ring | 277259 | |
| 70amp | Nozzle | 277124 | | 200amp | Electrode | 277135 | |
| 70amp | Swirl Ring | 277140 | | 260amp | Shield Cap | 277211 | |
| 70amp | Electrode | 277132 | | 260amp | Inner Cap | 277280 | |
| 100amp | Shield Cap | 277146 | | 260amp | Nozzle | 277118 | |
| 100amp | Inner Cap | 277113 | | 260amp | Swirl Ring | 277139 | |
| 100amp | Nozzle | 277126 | | 260amp | Electrode | 277135 | |
| 100amp | Swirl Ring | 277141 | | 400amp | Shield Cap | 284155 | |
| 100amp | Electrode | 277133 | | 400amp | Inner Cap | 284156 | |
| 150amp | Shield Cap | 277298 | | 400amp | Nozzle | 284158 | |
| 150amp | Inner Cap | 277266 | | 400amp | Swirl Ring | 284122 | |
| 150amp | Nozzle | 277297 | | 400 amp | Electrode | 284159 | |
| 150amp | Swirl Ring | 277139 | | 30 - 260amp | Outer Cap | 277154 | |
| 150amp | Electrode | 277135 | | 400 amp | Outer Cap | 284150 | |
| Swirl Ring Removal Tool | | 260105 | | O-Ring (Red-upper – Inner Cap) | | 500018 | |
| Nozzle Removal Tool | | 277056 | | O-Ring (Blue-lower – Inner Cap) | | 500024 | |
| Electrode Removal Tool Driver | | 277086 | | O-Ring (Black/Red – Outer Cap) | | 820209 | |
| Electrode Removal Socket | | 277087 | | O-Ring Lubricant | | 716012 | |
| Electrode Removal Socket - 400amp | | 284052 | | Torch Handle Assembly | | 820134 | |
| Coolant 1-gallon | | 500695 | | Torch Handle Assembly - 400amp only | | 278001 | |

Spirit/ProLine/FineLine Consumable Order Form

| | |
|------------------------|----------------------|
| Company Name: | Phone Number: |
| Contact Name: | Fax Number: |
| E-mail Address: | PO Number: |
| Ship To: | Pages Sent: |

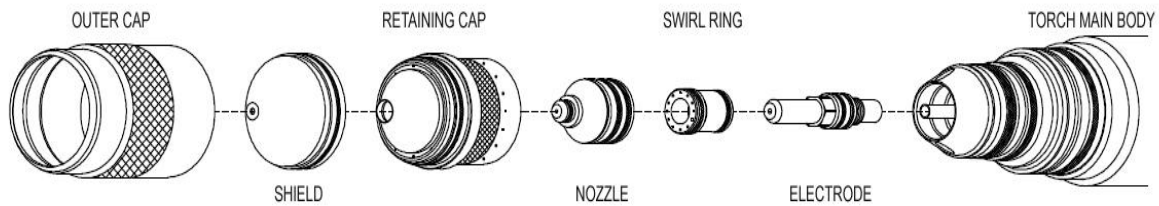

ALUMINIUM

| Amperage | Part | Reference | Qty | Amperage | Part | Reference | Qty |
|-----------------------------------|------------|-----------|-----|-------------------------------------|------------|-----------|-----|
| Systems <275amp | Torch Body | 277000 | | 150amp | Shield Cap | 277117 | |
| 400amp Systems | Torch Body | 278000 | | 150amp | Inner Cap | 277152 | |
| 30amp | Shield Cap | 277145 | | 150amp | Nozzle | 277293 | |
| 30amp | Inner Cap | 277153 | | 150amp | Swirl Ring | 277139 | |
| 30amp | Nozzle | 277120 | | 150amp | Electrode | 277292 | |
| 30amp | Swirl Ring | 277140 | | 200amp | Shield Cap | 277274 | |
| 30amp | Electrode | 277130 | | 200amp | Inner Cap | 277266 | |
| 50amp | Shield Cap | 277150 | | 200amp | Nozzle | 277289 | |
| 50amp | Inner Cap | 277153 | | 200amp | Swirl Ring | 277143 | |
| 50amp | Nozzle | 277122 | | 200amp | Electrode | 277291 | |
| 50amp | Swirl Ring | 277142 | | 275amp | Shield Cap | 277263 | |
| 50amp | Electrode | 277131 | | 275amp | Inner Cap | 277266 | |
| 70amp | Shield Cap | 277150 | | 275amp | Nozzle | 277276 | |
| 70amp | Inner Cap | 277153 | | 275amp | Swirl Ring | 277258 | |
| 70amp | Nozzle | 277125 | | 275amp | Electrode | 277270 | |
| 70amp | Swirl Ring | 277142 | | 400amp | Shield Cap | 284155 | |
| 70amp | Electrode | 277131 | | 400amp | Inner Cap | 284156 | |
| 100amp | Shield Cap | 277286 | | 400amp | Nozzle | 284158 | |
| 100amp | Inner Cap | 277151 | | 400amp | Swirl Ring | 284122 | |
| 100amp | Nozzle | 277284 | | 400 amp | Electrode | 284159 | |
| 100amp | Swirl Ring | 277283 | | 30 - 275amp | Outer Cap | 277154 | |
| 100amp | Electrode | 277282 | | 400 amp | Outer Cap | 284150 | |
| Swirl Ring Removal Tool | | 260105 | | O-Ring (Red-upper – Inner Cap) | | 500018 | |
| Nozzle Removal Tool | | 277056 | | O-Ring (Blue-lower – Inner Cap) | | 500024 | |
| Electrode Removal Tool Driver | | 277086 | | O-Ring (Black/Red – Outer Cap) | | 820209 | |
| Electrode Removal Socket | | 277087 | | O-Ring Lubricant | | 716012 | |
| Electrode Removal Socket - 400amp | | 284052 | | Torch Handle Assembly | | 820134 | |
| Coolant 1-gallon | | 500695 | | Torch Handle Assembly - 400amp only | | 278001 | |